

BYGNING 306

Nr.	Pronestor Navn	Lokale Type	Syllabus	Normal Drift	Kommentar
1	Forside				
2	B306-A032	Auditorium	194	196	
3	B306-A033	Auditorium	194	196	
4	B306-A034	Auditorium	194	196	
5	B306-A035	Auditorium	194	197	
6	B306-H031	Holdlokale	58	59	
7	B306-H036	Holdlokale	59	73	
8	B306-H096	Holdlokale	30	31	
9	B306-H097	Holdlokale	30	31	
10	B306-H098	Holdlokale	30	31	
11	B306-H099	Holdlokale	30	31	
12	B306-H108A&H108B	Holdområde	48+48	44+48	
13	B306-H000vest	Holdområde	40	48	
14	B306-H001øst	Holdområde	20	24	
15	B306-H001vest	Holdområde	25	30	

CTRL+Klik for at følge link

1.sal

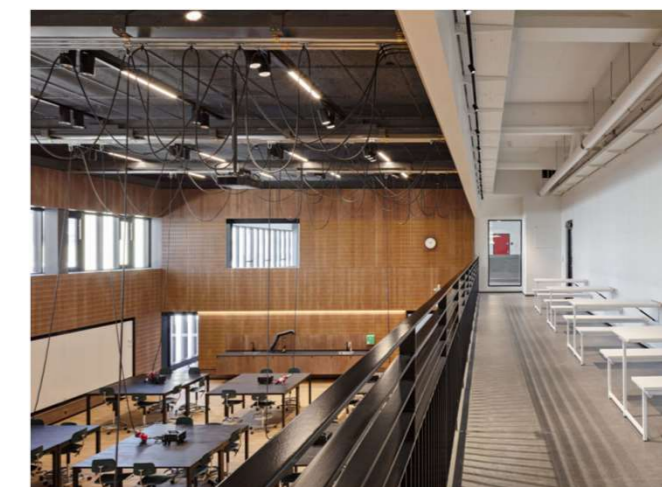
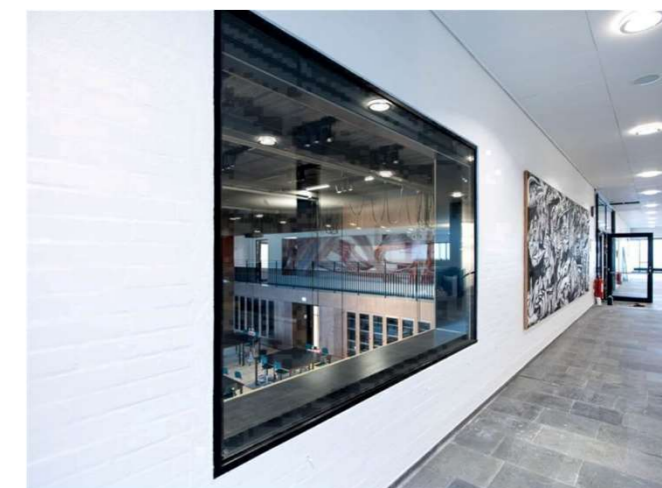
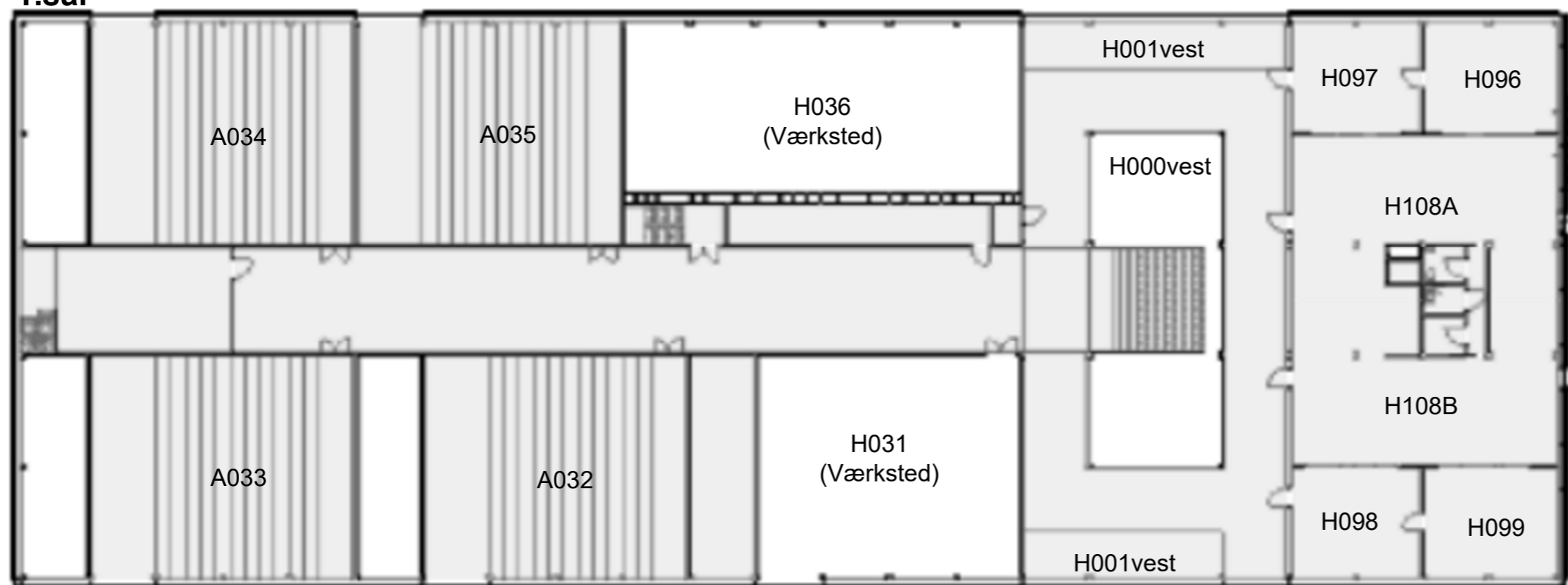



Inventaropstillingsplan - Normal drift

Matematiktorvet, Bygning 306, Auditorium A032, 2800 Kgs. Lyngby

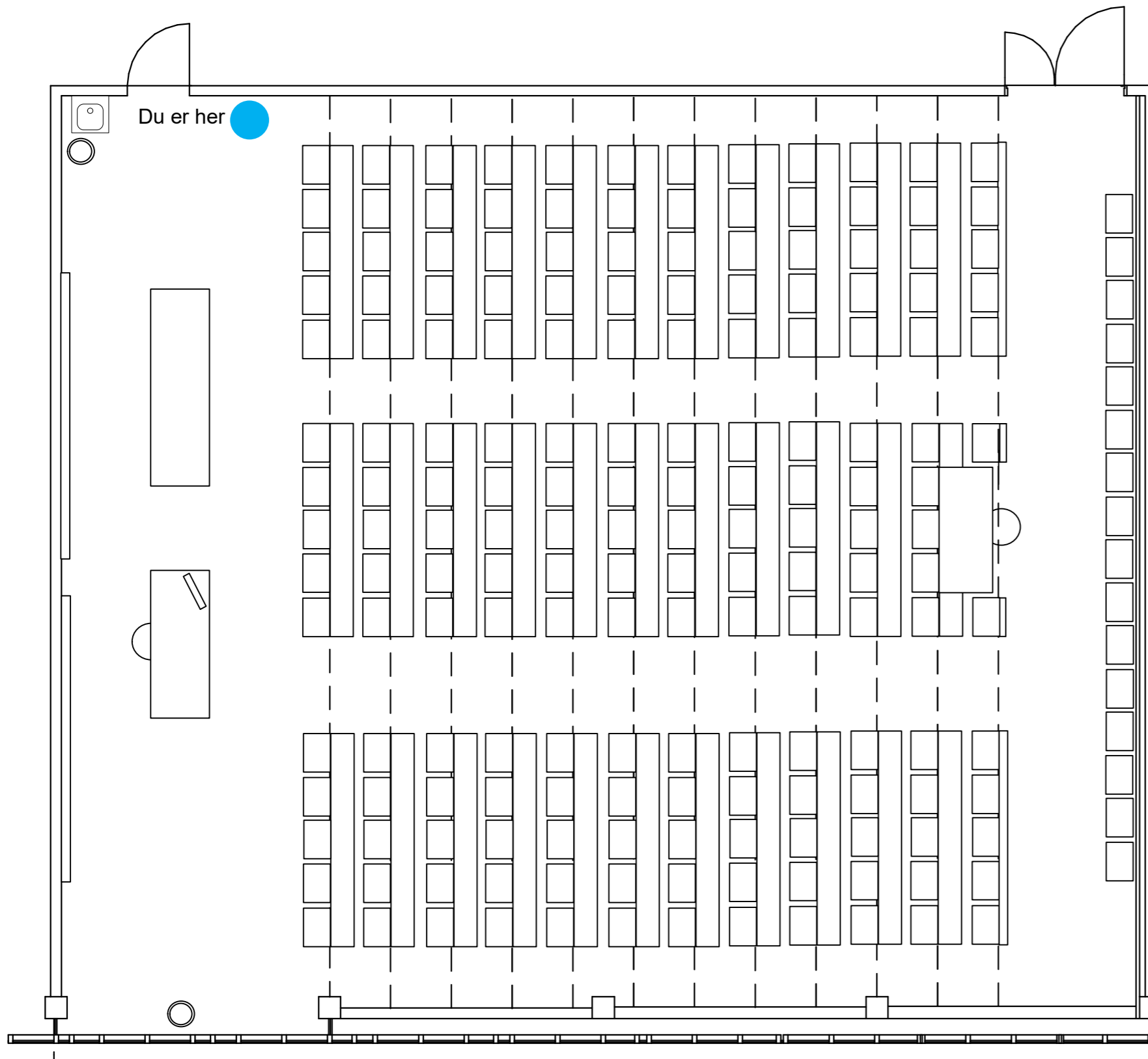

Inventaropstilling:

- 194 sæder + 2 stole
- 2 pulte (238 / 260 x 80 cm)



Inventaropstillingsplan - Normal drift

Matematiktorvet, Bygning 306, Auditorium A033, 2800 Kgs. Lyngby

Inventaropstilling:

- 194 sæder + 2 stole
- 2 pulte (238 / 260 x 80 cm)

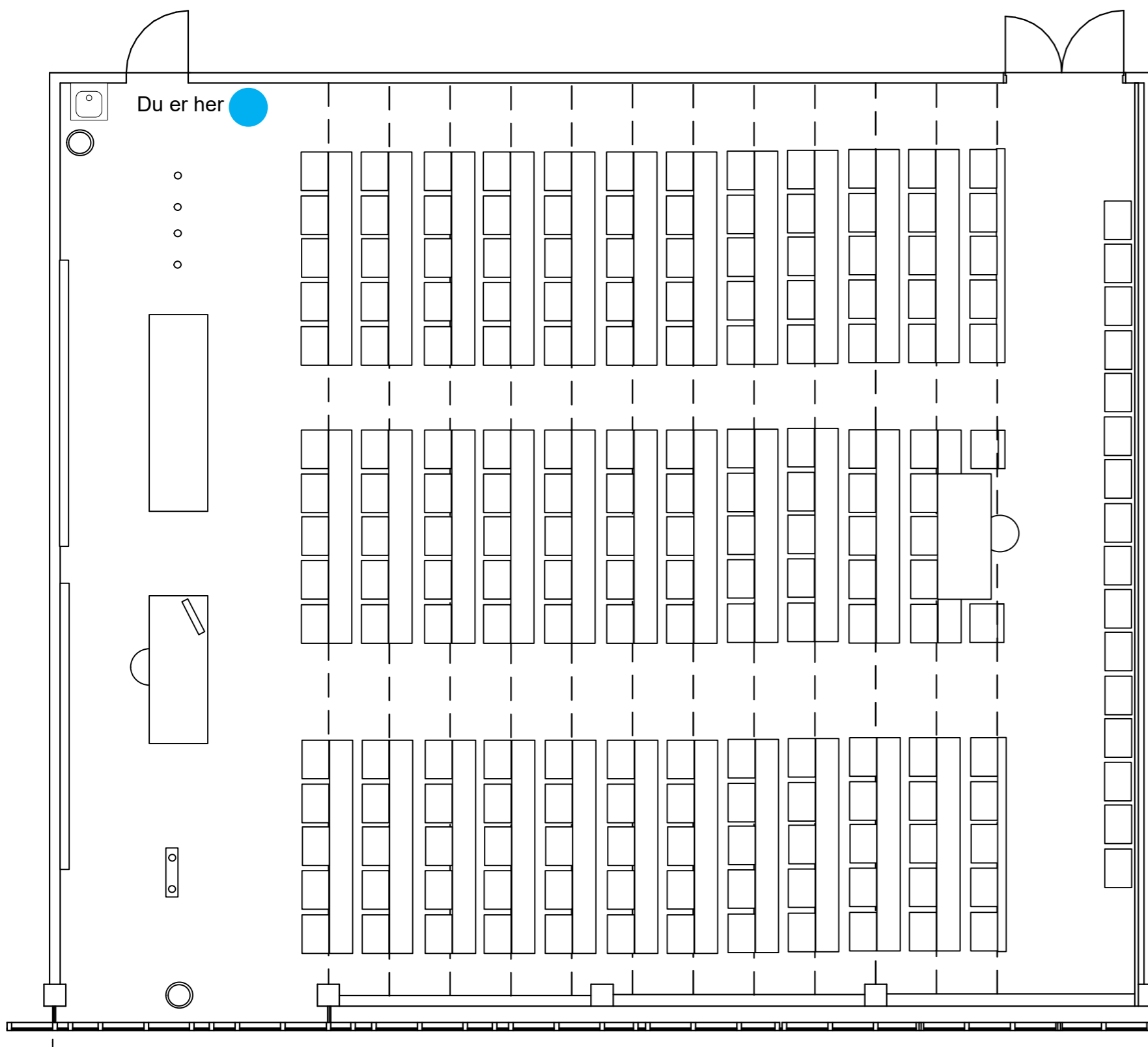



Inventaropstillingsplan - Normal drift

Matematiktorvet, Bygning 306, Auditorium A034, 2800 Kgs. Lyngby

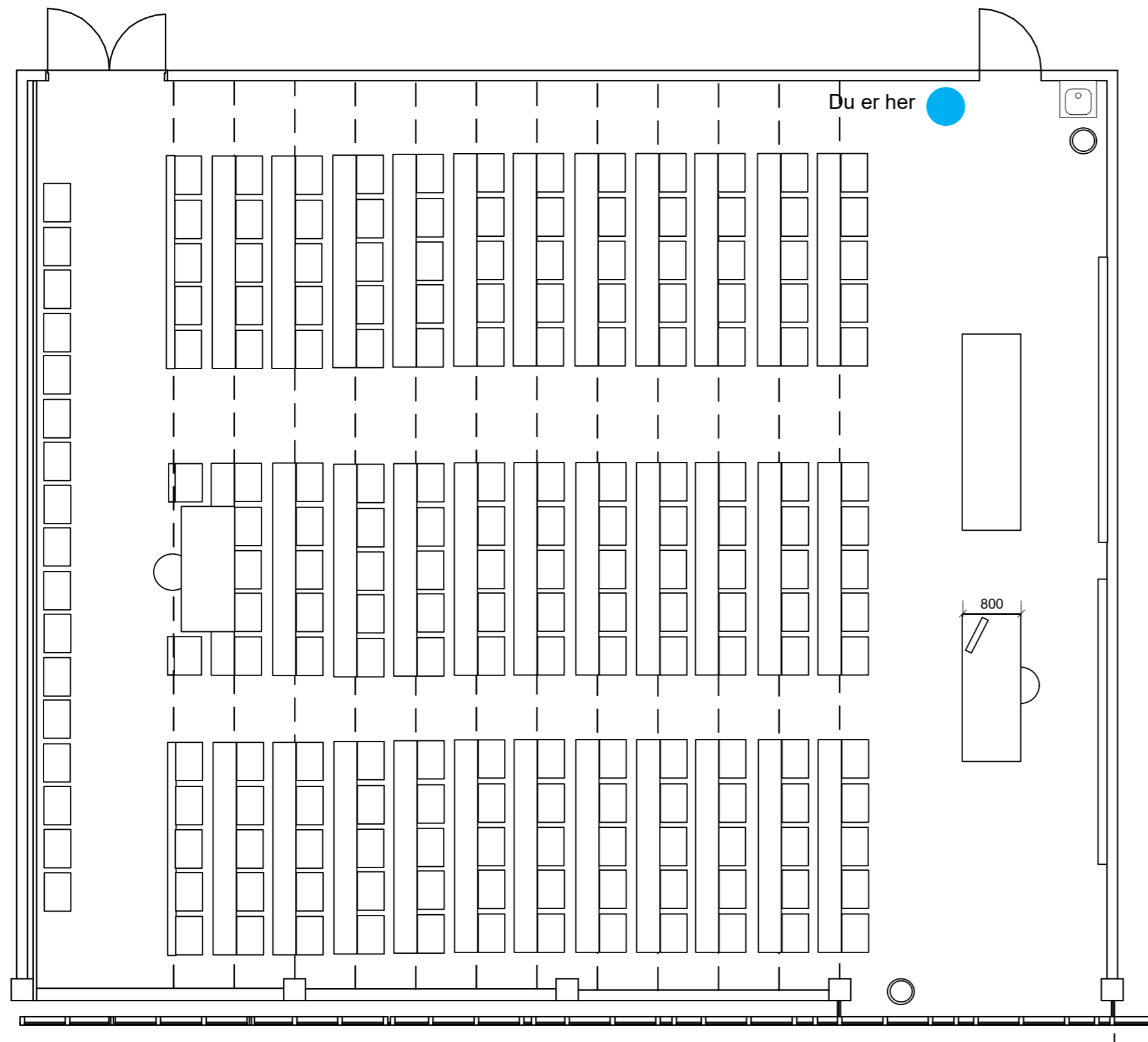

Inventaropstilling:

- 194 sæder + 2 stole
- 2 pulte (238 / 260 x 80 cm)



Inventaropstillingsplan - Normal drift

Matematiktorvet, Bygning 306, Auditorium A035, 2800 Kgs. Lyngby

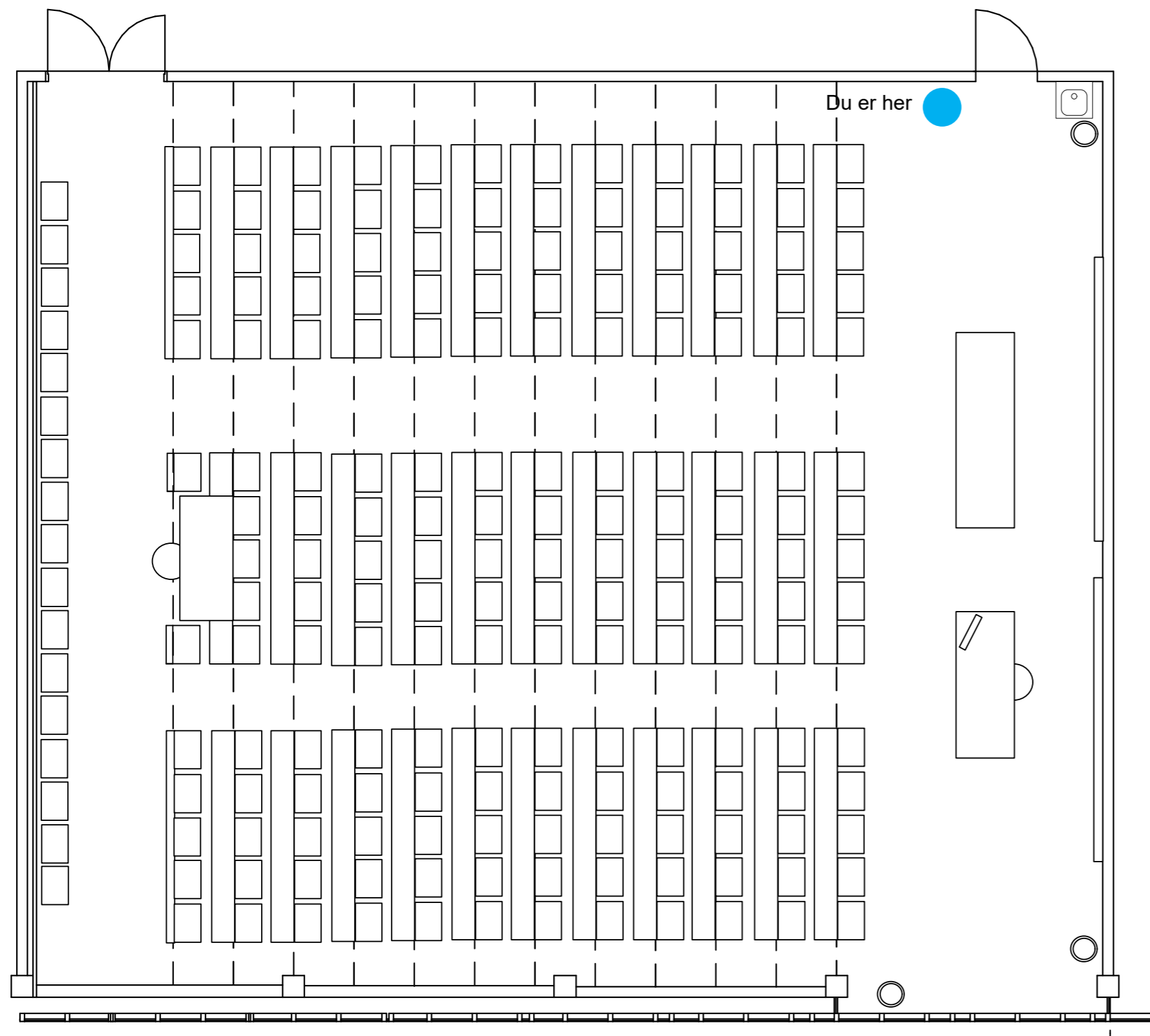

Inventaropstilling:

- 195 sæder + 2 stole
- 2 pulte (238 / 260 x 80 cm)



Inventaropstillingsplan - Normal drift

Matematiktorvet, Bygning 306, Holdlokale H031, Eksperimentelt værksted, 2800 Kgs. Lyngby

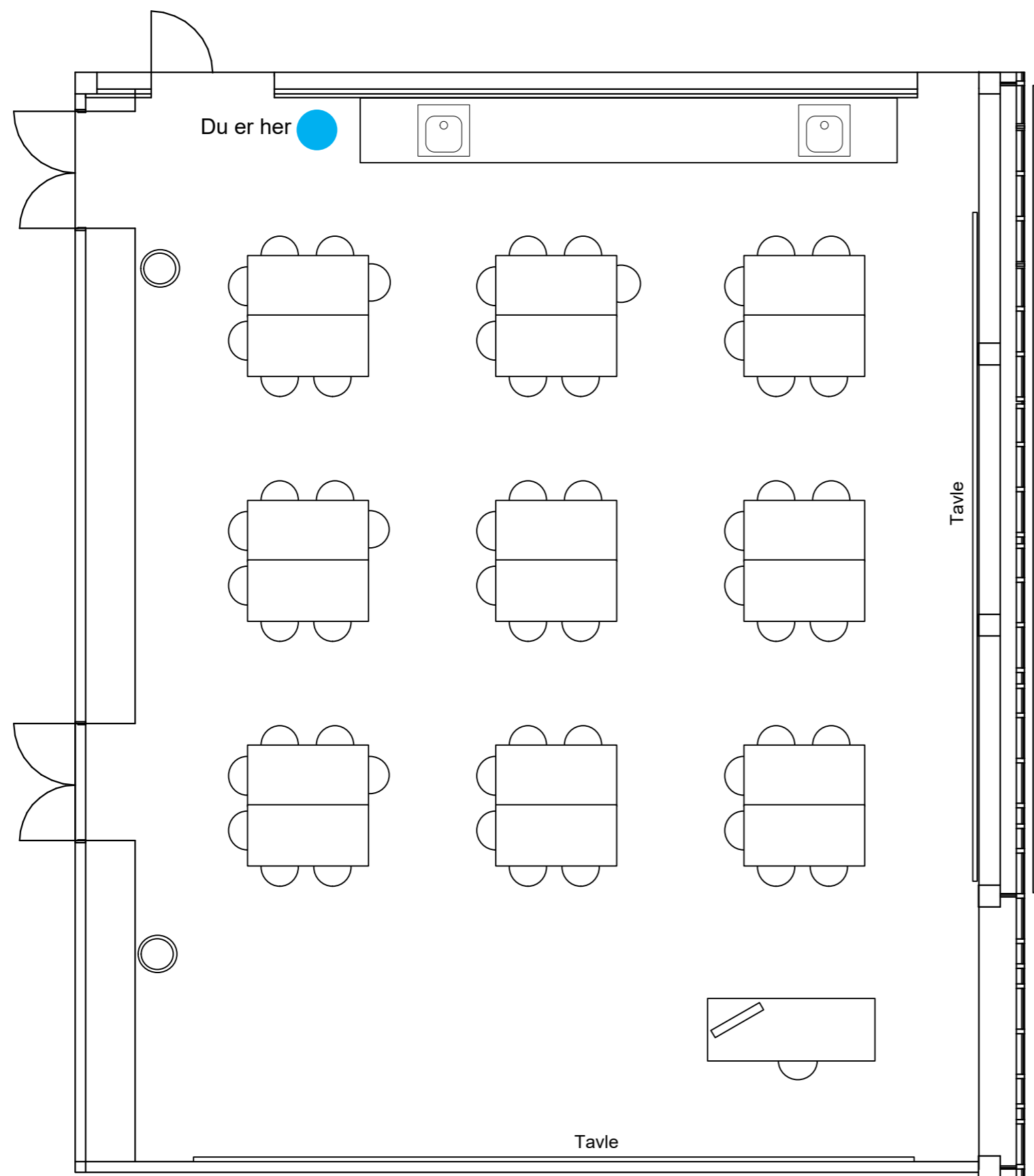

Inventaropstilling:

- 18 borde (100 x 180 cm)
- 1 pult (80 x 200 cm)
- 59 stole



Inventaropstillingsplan - Normal drift

Matematiktorvet, Bygning 306, Holdlokale H036, Eksperimentelt værksted, 2800 Kgs. Lyngby

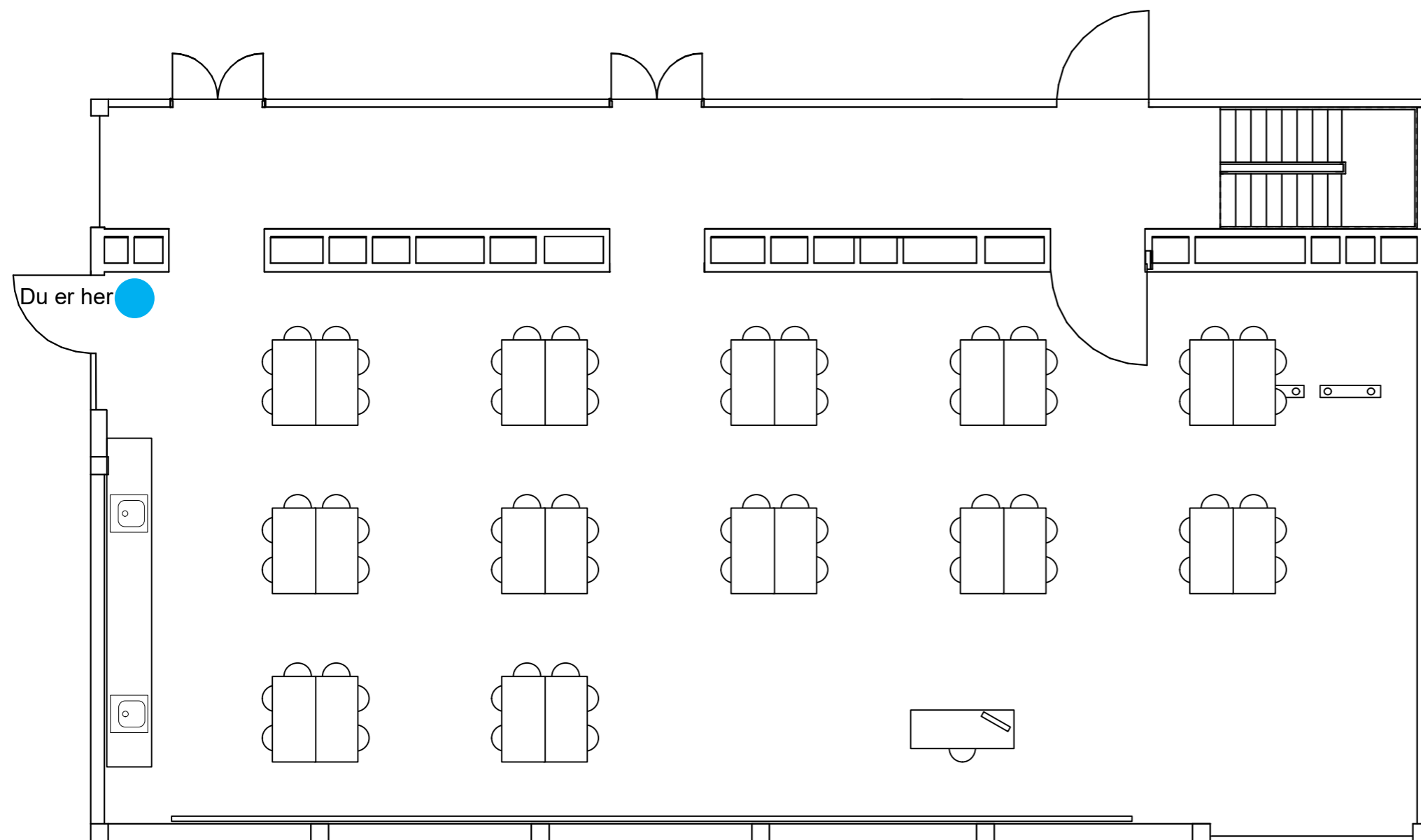

Inventaropstilling:

- 24 borde (90 x 180 cm)
- 1 pult (80 x 200 cm)
- 73 stole



Inventaropstillingsplan - Normal drift

Matematiktorvet, Bygning 306, 1sal, Holdlokale H096, 2800 Kgs. Lyngby

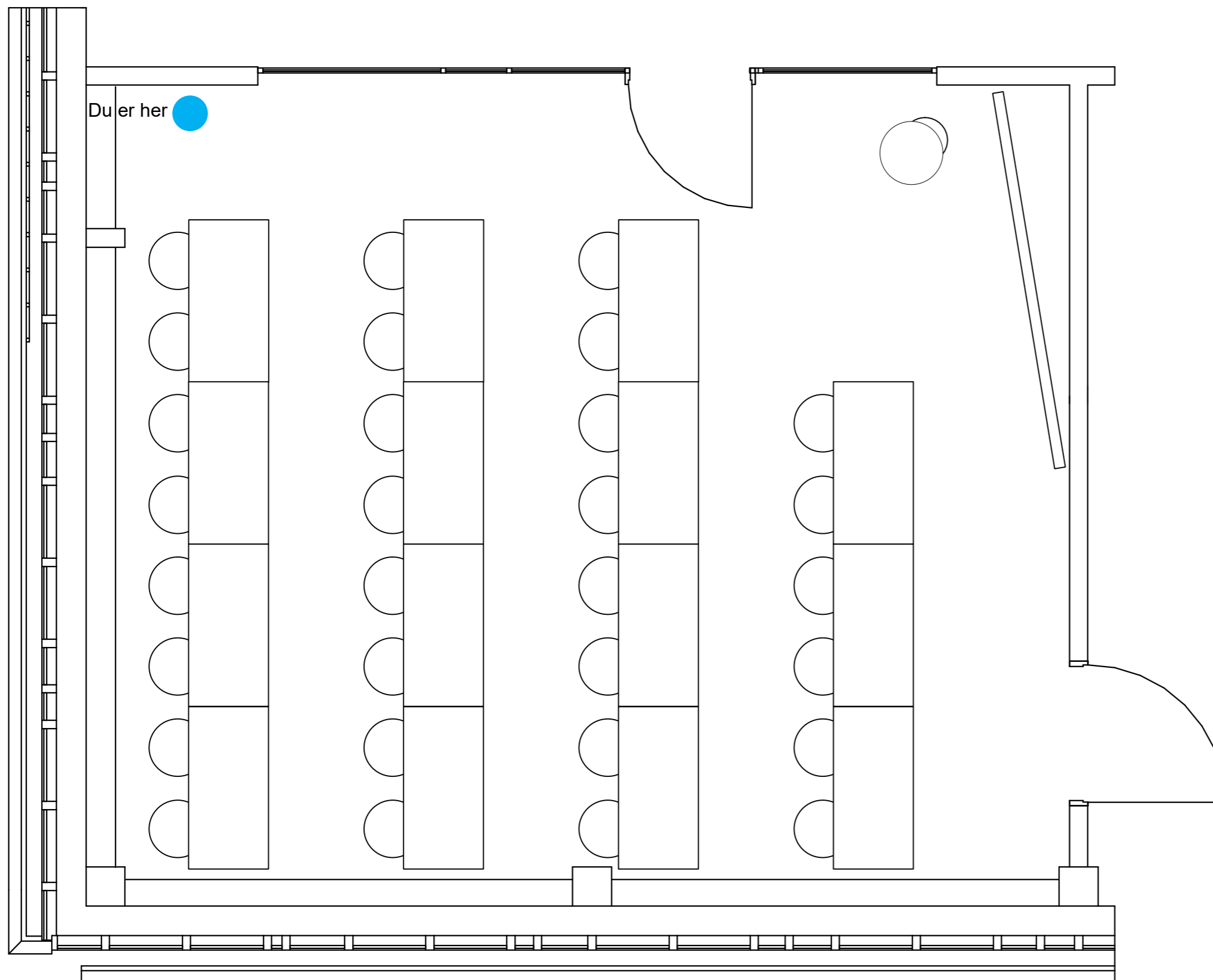

Inventaropstilling:

- 15 borde (128 x 64 cm)
- 31 stole
- 1 cafébord (til underviser)



Inventaropstillingsplan - Normal drift

Matematiktorvet, Bygning 306, 1sal, Holdlokale H097, 2800 Kgs. Lyngby

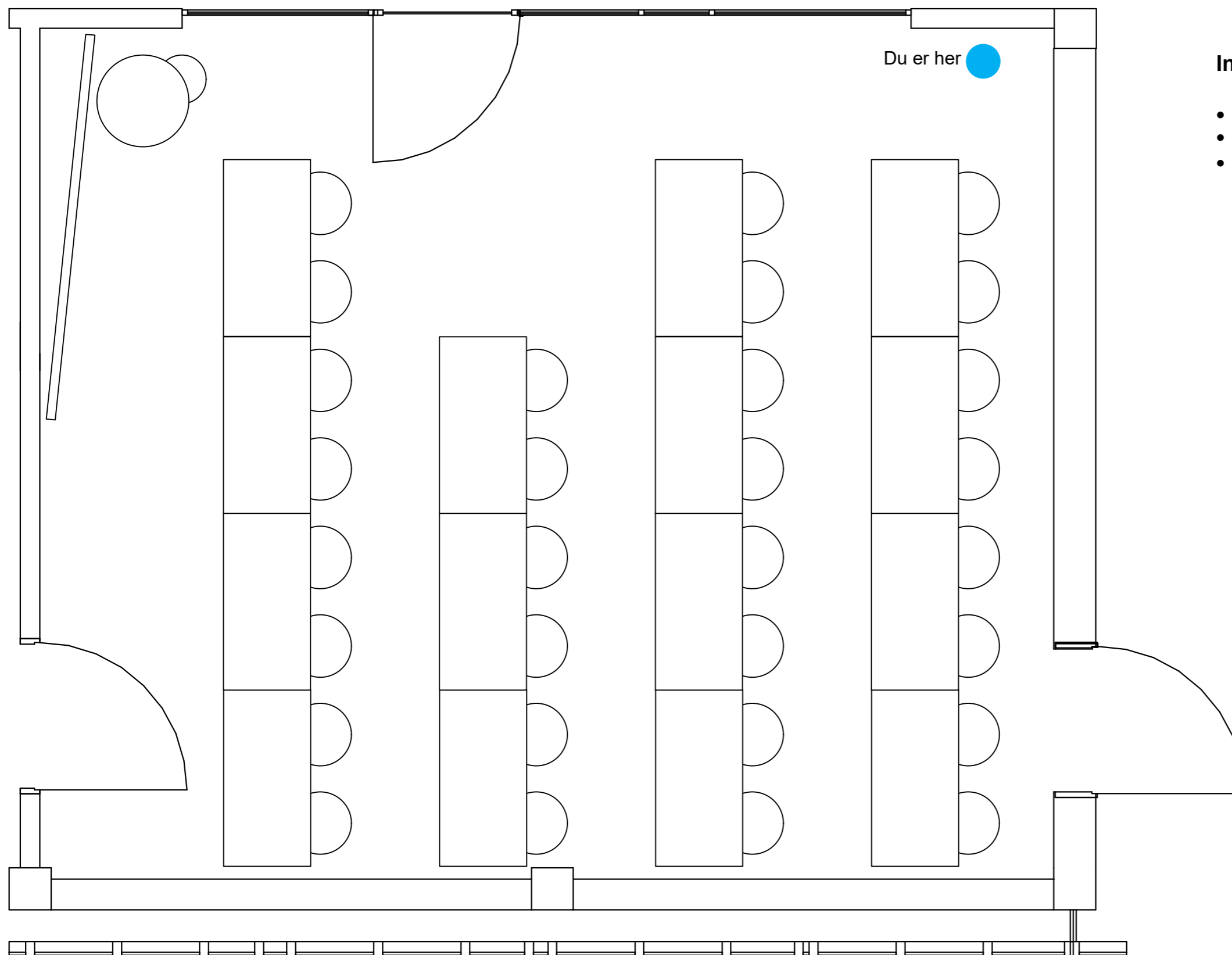

Inventaropstilling:

- 15 borde (64 x 128 cm)
- 31 stole
- 1 cafébord (til underviser)



Inventaropstillingsplan - Normal drift

Matematiktorvet, Bygning 306, 1sal, Holdlokale H098, 2800 Kgs. Lyngby

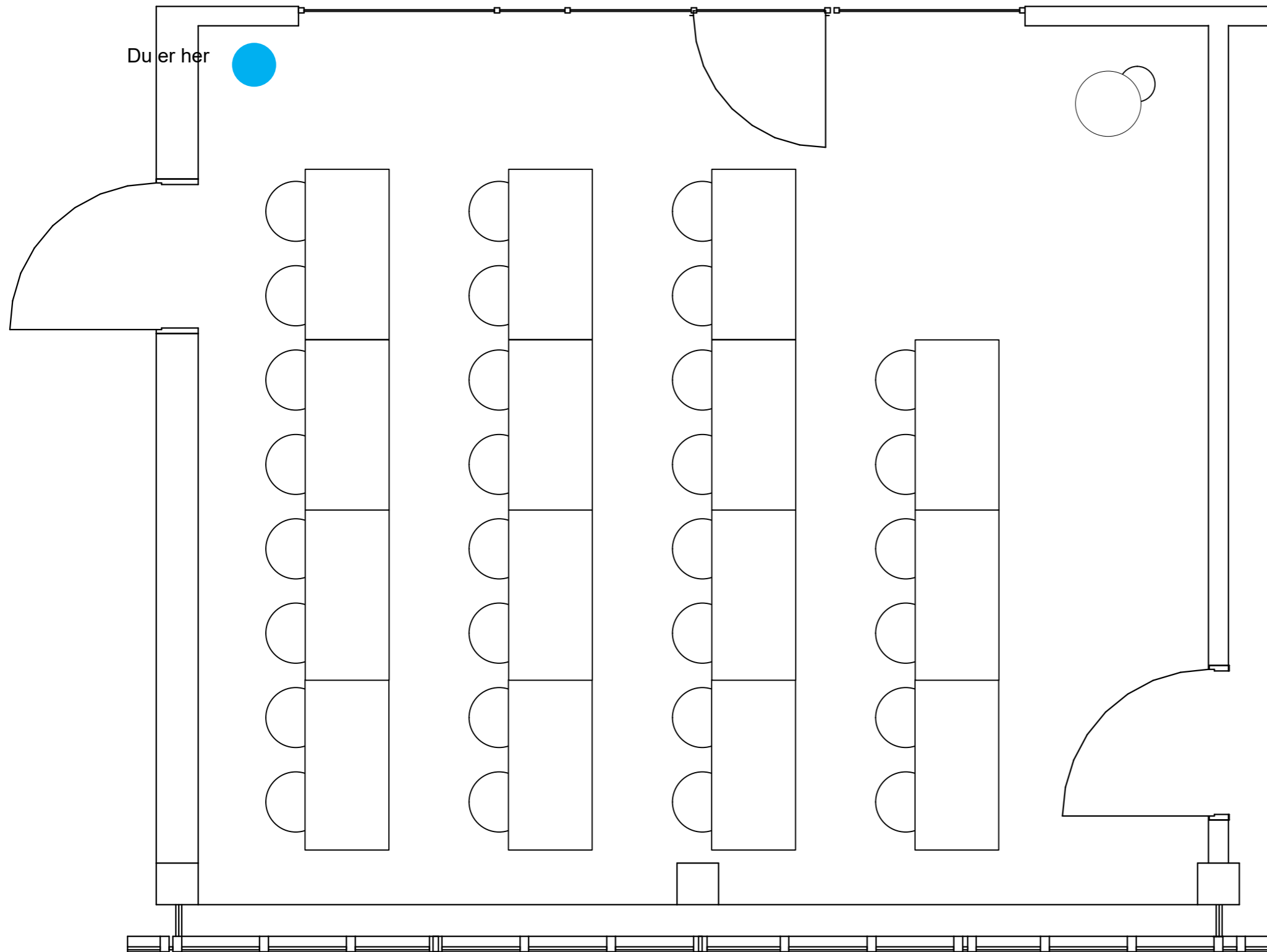

Inventaropstilling:

- 15 borde (128 x 64 cm)
- 31 stole
- 1 cafébord (til underviser)



Inventaropstillingsplan - Normal drift

Matematiktorvet, Bygning 306, 1sal, Holdlokale H099, 2800 Kgs. Lyngby

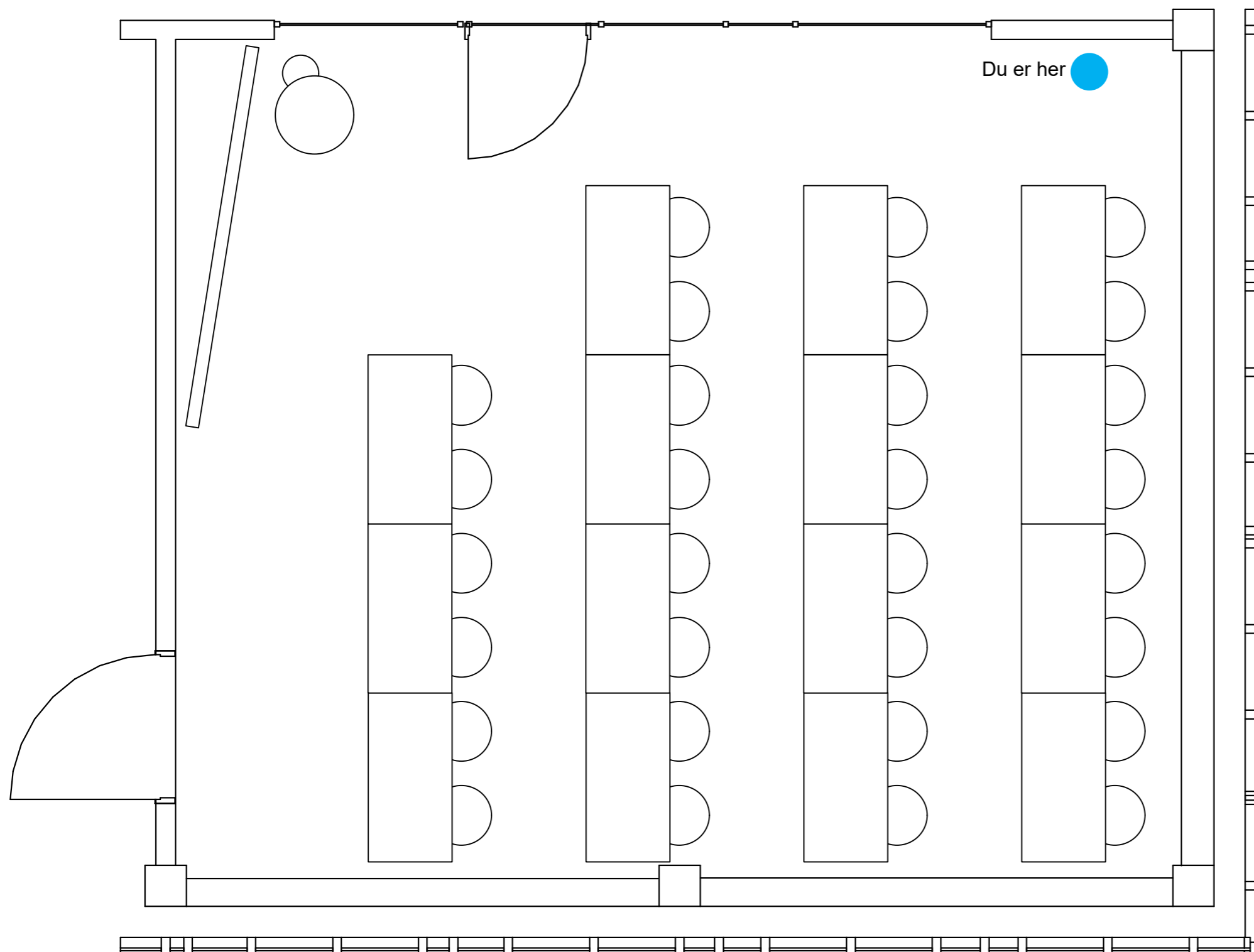

Inventaropstilling:

- 15 borde (64 x 128 cm)
- 31 stole
- 1 cafébord (til underviser)



Inventaropstillingsplan - Normal drift

Matematiktorvet, Bygning 306, 1sal, Lokale H108A og H108B, 2800 Kgs. Lyngby

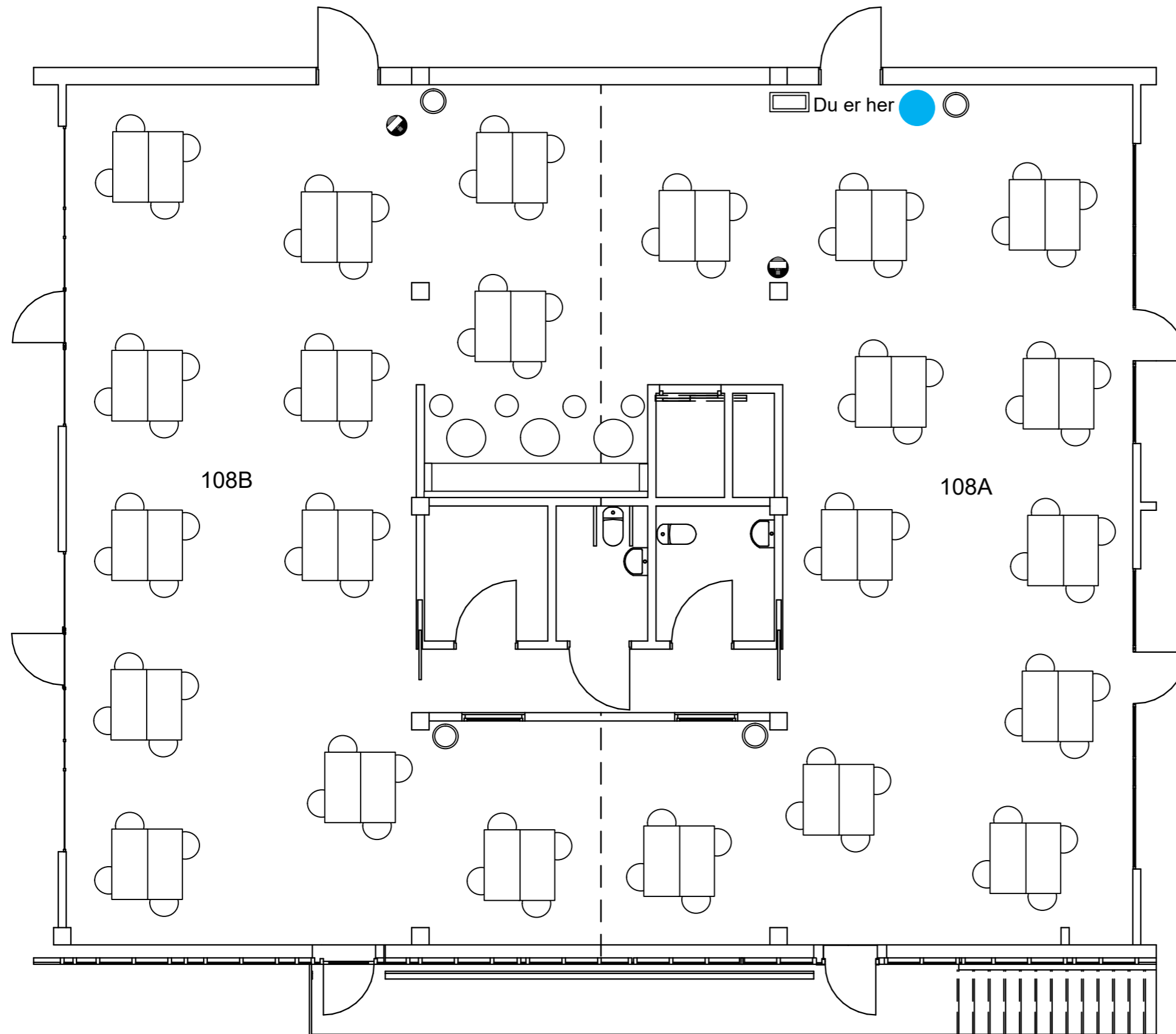

Inventaropstilling:

H108A

22 borde (64 x 128 cm)
44 stole

H108B

24 borde (64 x 128 cm)
48 stole
1 sofa
3 caféborde
4 caféstole



Inventaropstillingsplan - Normal drift

Matematiktorvet, Bygning 306, Holdområde H000 Vest, 2800 Kgs. Lyngby

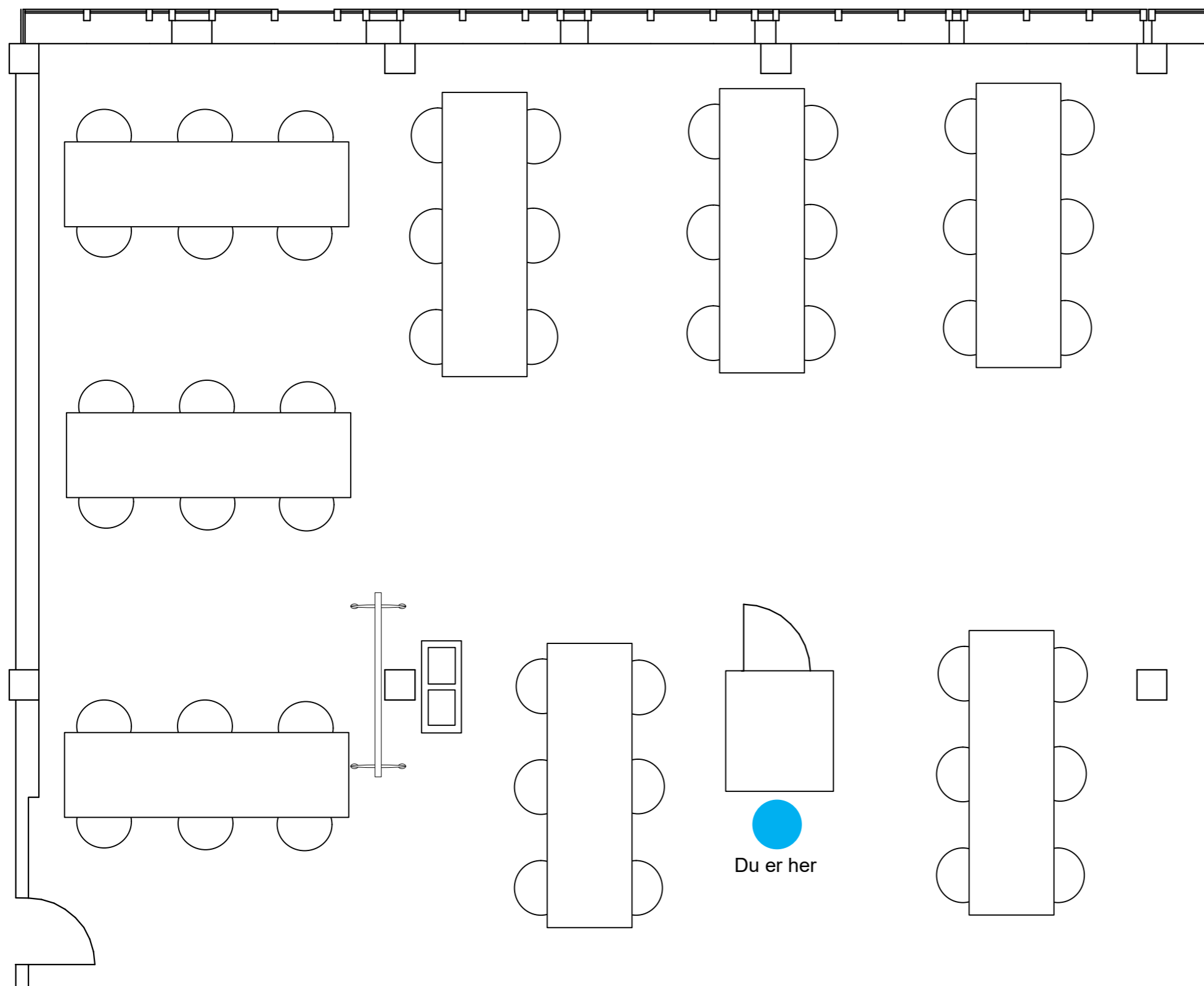

Inventaropstilling:

- 8 borde (250 x 90 cm)
- 48 stole (FourCast)



Inventaropstillingsplan - Normal drift

Matematiktorvet, Bygning 306, Holdområde H001 Øst, 2800 Kgs. Lyngby

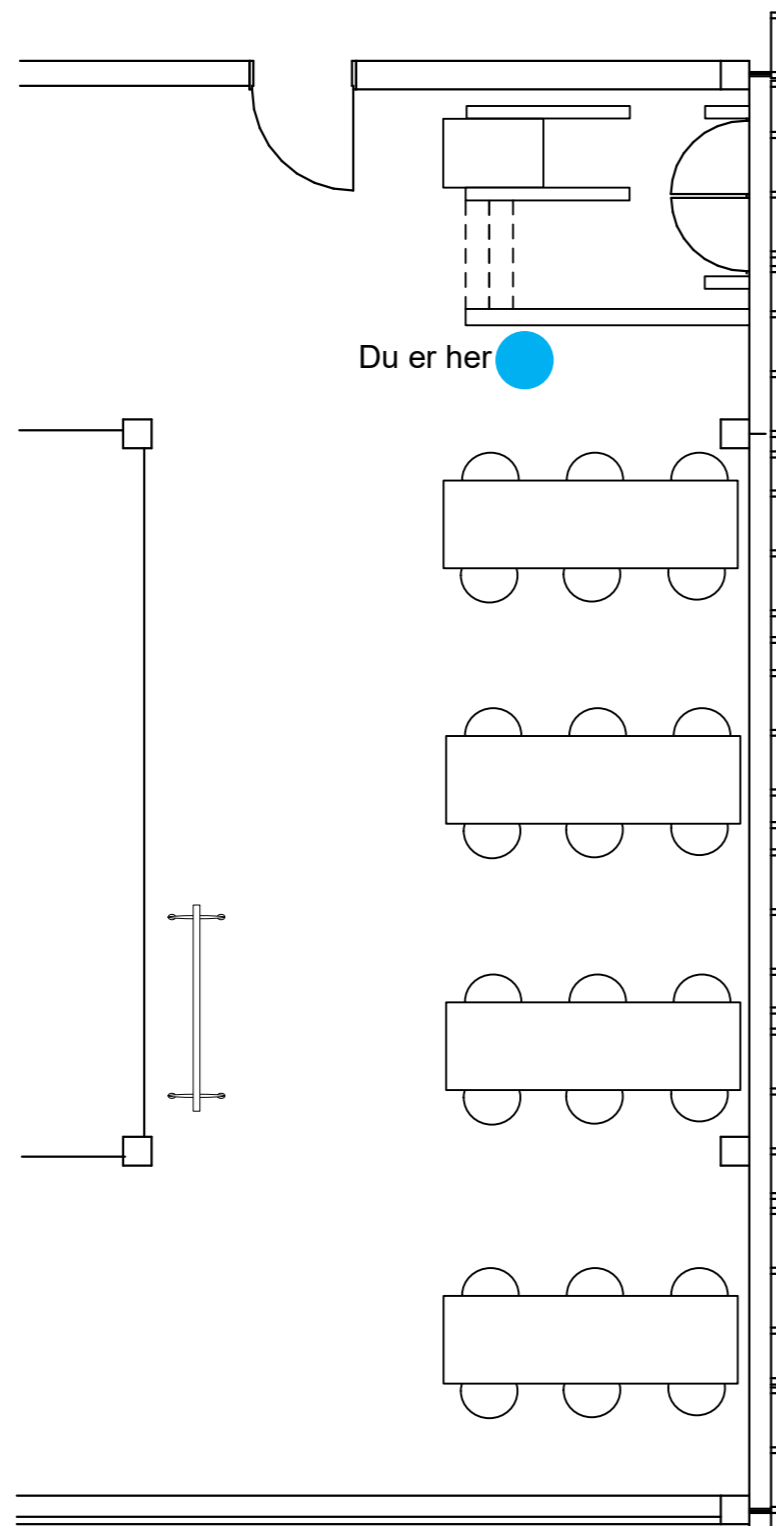

Inventaropstilling:

- 4 borde (250 x 90 cm)
- 24 stole (FourCast)



Inventaropstillingsplan - Normal drift

Matematiktorvet, Bygning 306, Holdområde H001 Vest, 2800 Kgs. Lyngby

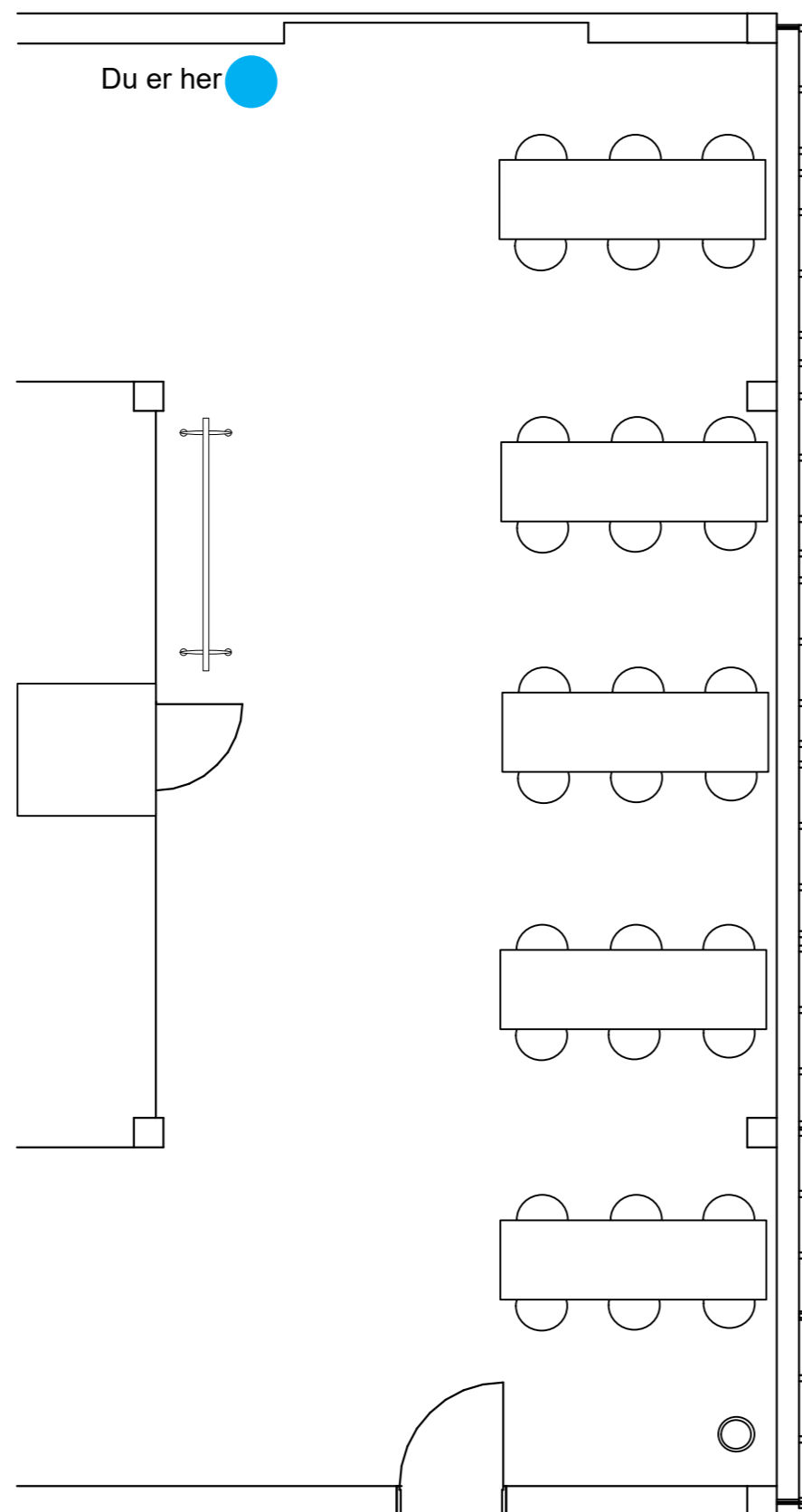

Inventaropstilling:

- 5 borde (250 x 90 cm)
- 30 stole (FourCast)